

# Columbus



**FOREST RIVER**

[FORESTRIVERINC.COM](http://FORESTRIVERINC.COM)

# STANDARDS AND OPTIONS

## CONSTRUCTION

- 101" Wide Body
- Patented 7' Upper Deck Height
- All Welded Aluminum Frame Superstructure
- Climate Controlled Drop-Frame Storage
- 5/8" Tongue & Groove Plywood Floor
- Residential Style 2 1/2" Wide Wood Truss Roof with Alpha Ply Membrane w/Extended Life Sealant and 1/2" Decking (8' x 8' Sheets)
- 6' 11" Height Slides (Living Area)
- Heat Ducts in Out-of-Traffic Areas
- 3 Zone LED Strip Ceiling Lighting
- 12V Heat Pads on All Holding Tanks
- Darco Wrap & Fiberglass Insulated Floors & Roof
- 2" Sidewall with Foam Insulation
- MORryde CRE3000 Suspension System
- High Gloss Fiberglass Vacuum Bonded Walls and Slideout Endwalls w/Dual Azdel
- 7000 Lb Lippert™ Axles with ABS (Anti-Lock Braking System)
- 16" Wheels with Tire Pressure Monitoring System
- Painted Fiberglass Front Cap with High Density Spray Foam Insulation
- Rear-View Camera Prep
- Slide Topper Prep

## INTERIOR

- Soft-Close, Hidden-Hinge Reinforced Doors & Drawers w/Upgraded Hardware
- Upgraded Crack, Mold, & Mildew Resistant Flooring
- Upgraded, True Solid Surface Countertops (Bath/Kitchen)
- LED Light Fixtures
- Residential Style Crown Molding Throughout Unit
- Solid Wood Slide Fascia
- Roller Day/Night Shades (Main Areas)
- Solid Wood Steps

## EXTERIOR

- Large Frameless Tinted Windows
- Slam Latches on All Storage Doors
- Magnetic Compartment Door-Holds
- Two-Tone Aluminum Wheels
- Painted Fiberglass Front Cap with High Density Spray Foam Insulation
- Heated Utility Convenience Center
- Black Tank Flush
- Outside Sprayer
- Two 30 Lb LP Tanks
- Entry Door w/Window & Screen Door
- Battery Disconnect
- Power Awning with LED Lighting
- Crank-Down Spare Tire
- 2" Tow Hitch w/4-Way Pin Plugs
- Tire Pressure Monitoring System

## KITCHEN

- Trash Can with Dedicated Storage
- Rollaway Sink Covers
- Residential Style Under-Counter Storage
- Residential Style Backsplash
- Additional Lighting Above Sink Area
- Large Single Basin Stainless Steel Sink
- Single-Lever Faucet with Pull-Out Sprayer

## BEDROOM

- Mirrored Sliding Closet Doors
- High-End Bedspread & Pillows
- Reading Lights with USB Charging Ports
- C-Pap Shelves (Per Model)
- Smart TV
- Dresser w/Solid Wood Soft Close Drawers

## BATHROOM

- 48" x 30" One Piece Fiberglass Shower w/Built-in Seat
- Undermount Porcelain Sink
- Three-Speed Power Vent
- Porcelain Toilet
- Shower Skylight

## FURNITURE

- Power Theater Seating with USB Charging & Storage
- Trifold Sleeper Sofa
- (2) Residential Style Dining Chairs
- (2) Folding Chairs
- Wall Mounted Free-Standing Dinette Table w/Drawer

## APPLIANCES

- 12V Stainless Steel Residential Style Refrigerator with Ice Maker
- Gas Cooktop
- 24" Residential Style Oven (N/A 388FKH)
- 50" Smart TV w/Bluetooth® Audio and Exterior Speakers
- 12 Gal Water Heater with Quick Recovery
- Washer/Dryer Prep
- Full-System Water Purifier
- 30" Residential Style Stainless Steel Microwave
- (2) 15,000 BTU Coleman Ducted Serenity A/Cs (Zone 2 w/Heat Pump)
- 35,000 BTU Furnace
- 5,000 BTU Electric Fireplace (2 on 380RL)
- Omni-Directional Rooftop Antenna with 4G LTE/Wi-Fi Prep
- 50 Amp Converter w/ Built-in Charge Wizard & Auto Lithium Detect

## OPTIONS

- Stackable Washer/Dryer
- Dual-Pane Windows
- Full-Body Paint
- Slide Toppers
- 2<sup>ND</sup> 260W Solar Panel
- 3<sup>RD</sup> Ducted A/C Installed IPO MaxxAir Vent
- 5.5KW Onan Generator

# MANDATORY PACKAGES

## COMFORT PACKAGE

### INTERIOR

- Upgraded Residential Style Hardware
- Privacy Day/Night Roller Shades in Main Areas
- Pop-Up Recept
- Hybrid Carpet

### APPLIANCES

- Dishwasher Prep
- Washer/Dryer Prep
- Stainless Steel Appliance Package Including Microwave, Gas Cooktop & 12V Fridge w/Ice Maker
- Living Room Ceiling Fan
- 50" Smart TV w/Bluetooth® Audio
- Bedroom Smart TV
- 5000 BTU Electric Fireplace

### FURNITURE

- Power Theater Seating w/USB Charge
- Trifold Sleeper Sofa
- Wall Mounted Free-Standing Dinette Table w/Drawer
- (2) Residential Style Dinette Chairs
- 2 Folding Chairs
- Large Kitchen Pantry (Select Models)

### BATHROOM

- 48" x 30" One Piece Shower w/Built-in Seat
- Undermount Bath Sink with Solid Surface Tops
- Porcelain Toilet
- Aluminum Framed Bed Base
- 3<sup>RD</sup> A/C Prep w/Kitchen MaxxAir Vent

## VOYAGER PACKAGE

### CONSTRUCTION

- 6 Point Hydraulic Leveling System
- MORryde CRE3000 Suspension
- MORryde Upgraded Pinbox
- MORryde Strut Assist Step Above Entry Steps
- 7000 Lb Axles with ABS (Anti-Lock Braking System)
- High Gloss Fiberglass Vacuum Bonded Walls w/Dual Azdel Onboard
- Two-Tone Painted Front Cap w/High Density Spray Foam Insulation
- 12V Heat Pads on Tanks
- Back Up Camera Prep
- Slide Topper Prep
- Ladder
- LP Quick Connect

### EXTERIOR

- Two-Tone Aluminum Wheels
- Tire Pressure Monitoring System
- 2" Tow Hitch w/4-Way Pin Plugs
- Frameless Windows
- Battery Disconnect
- Power Awning w/LED Lighting
- Syphon 360 Vent Covers

### APPLIANCES

- (2) Quietcool 15K BTU Serenity A/Cs (Zone 2 w/Heat Pump)
- 12 Gal Water Heater
- Power Cord Storage Reel
- One Control Operating System
- Wi-Fi Booster w/4G LTE Capability Prep
- 260W Solar Panel w/30AMP Control w/1800W Inverter & Dedicated Recept

# FLOORPLANS

## 376DS

Dimensions	Weights	Tanks
Length: 42' 7"	UWV: 13719	Fresh: 75 Gal
Width: 101"	GVWR: 15999	Gray: 117 Gal
Height: 13' 6"	CCC: 2280	Black: 78 Gal
Awning: 9' 6", 16'	Hitch: 2615	

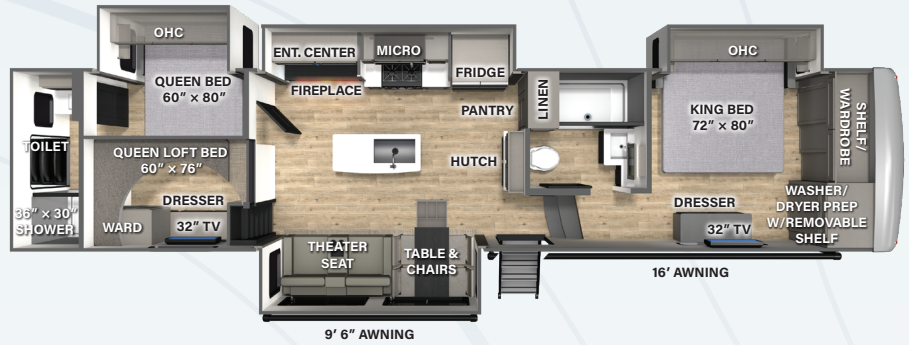

## 380RL

Dimensions	Weights	Tanks
Length: 37' 11"	UWV: 12854	Fresh: 75 Gal
Width: 101"	GVWR: 15499	Gray: 71 Gal
Height: 13' 6"	CCC: 2645	Black: 39 Gal
Awning: 11', 18'	Hitch: 2495	

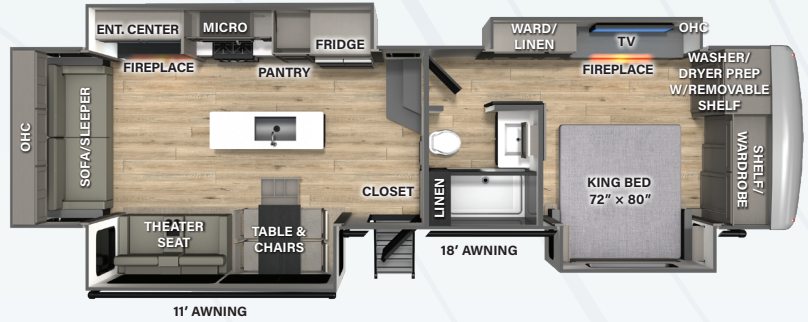

## 383RLH

Dimensions	Weights	Tanks
Length: 42' 2"	UWV: 13722	Fresh: 75 Gal
Width: 101"	GVWR: 15999	Gray: 78 Gal
Height: 13' 6"	CCC: 2277	Black: 78 Gal
Awning: 11', 18' 6"	Hitch: 2756	

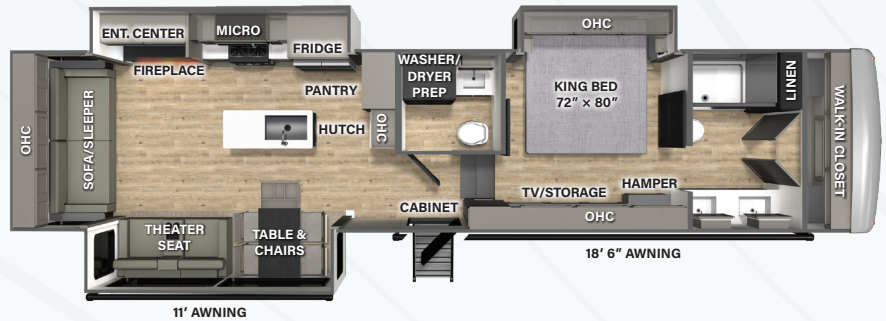

## 384RKH

Dimensions	Weights	Tanks
Length: 42' 7"	UWV: 13327	Fresh: 75 Gal
Width: 101"	GVWR: 15599	Gray: 78 Gal
Height: 13' 6"	CCC: 2272	Black: 71 Gal
Awning: 11', 20'	Hitch: 2457	

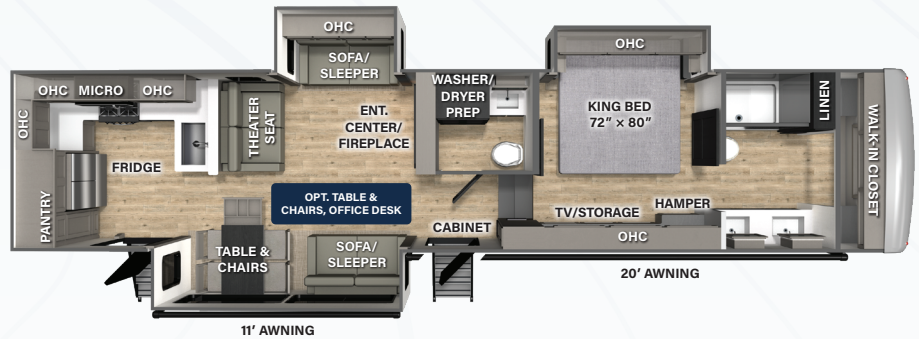

## 388FKH

Dimensions	Weights	Tanks
Length: 42' 10"	UWV: 14414	Fresh: 75 Gal
Width: 101"	GVWR: 16685	Gray: 117 Gal
Height: 13' 6"	CCC: 2271	Black: 78 Gal
Awning: 12', 18'	Hitch: 2685	

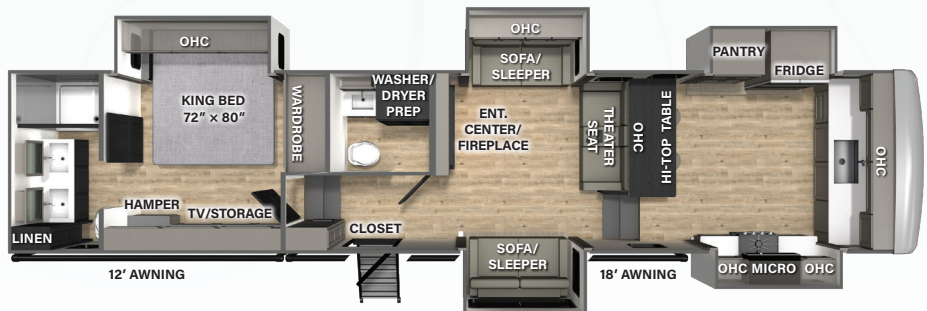

UWV stands for Unloaded Vehicle Weight. See back cover for further specification definitions.

# Columbus

A Division Of Forest River, Inc.  
105-1/2 C.R. 14  
Middlebury, In 46540  
[www.palominorv.com](http://www.palominorv.com)

Follow us!  
#RVBOUND

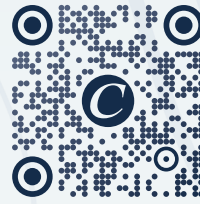

## SCAN WITH YOUR MOBILE DEVICE

VIRTUAL TOURS, PHOTOS, VIDEOS,  
FOLLOW COLUMBUS ON SOCIAL  
MEDIA, AND MORE!



### EACH NEW FOREST RIVER PURCHASE PROVIDES:

- ✔ Pre-delivery Inspection.      ✔ Digital Owner's Manual.
- ✔ Free Membership to Forest River Owners Group (FROG).  
Learn more at [www.forestriverfrog.com](http://www.forestriverfrog.com).
- ✔ A Contribution to Care Camps Foundation [www.carecamps.org](http://www.carecamps.org).
- ✔ 1 Year Free Roadside Assistance from Date of Purchase.



### LEARN MORE:

Scan this QR code with your mobile device to learn more about Forest River.



### SPECIFICATION DEFINITIONS:

Scan this barcode using a QR reader on your smartphone to learn RV terminology and more!



YOUR **COLUMBUS** DEALER